

# STAINLESS STEEL T CONDUIT BODIES

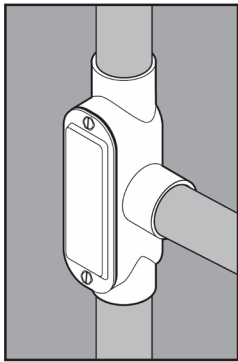

## APPLICATION

- Designed to make 90° turns, change the route of conduit, and/or to make wiring pulls and connections
- Flat back design provides extra wiring capacity
- Form 8
- Offered in seven configurations: C, LB, LL, LR, T, TB, X
- Supplied complete with cover, gasket and Type 316 SS screws
- Manufactured in stainless steel to help prevent corrosion
- Can be installed using ordinary hand tools and require little maintenance or repair
- Provided in a bright, polished finish that does not require touch up or painting

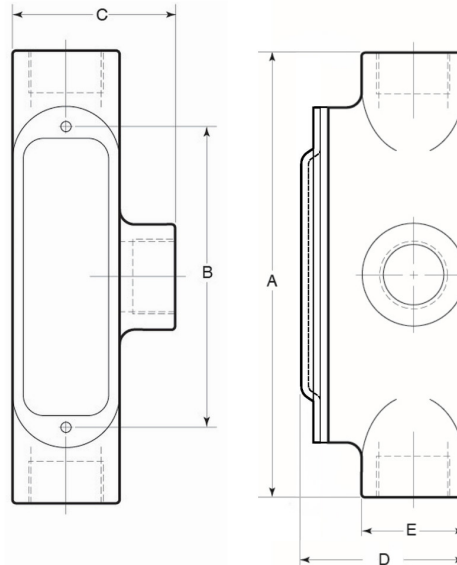

## PRODUCT DETAILS

### Material:

- Body: CF8M (316 SS)
- Cover, Screws: 316 SS
- Gasket: Neoprene

**Country of Origin:** 100%  
Made in USA

### UL File Number:

QCIT.E300676  
(Standard 514A)

### Canada UL File Number:

DWTT7.E300676  
(Standard 514A)

Part Number	Conduit Size	Weight/ Each (lbs.)	Dimension (in.)				
			A	B	C	D	E
7050T	½ in.	2	6.00	3.50	2.29	2.01	1.18
7075T	¾ in.	3	6.81	4.31	2.57	2.35	1.50
7100T	1 in.	4	8.00	5.00	2.94	2.65	1.75
7125T	1-¼ in.	5	9.13	6.00	3.43	2.86	2.15
7150T	1-½ in.	6	9.63	6.58	3.59	3.15	2.30
7200T	2 in.	9	12.13	8.50	4.46	3.80	2.73
7250T	2-½ in.	14	14.69	9.75	5.72	4.69	3.26
7300T	3 in.	19	15.10	11.25	5.85	5.06	4.04
7400T	4 in.	29	18.25	13.75	7.20	5.89	5.12

\* 7250T not yet UL Listed

