



# GIBSON STAINLESS® & SPECIALTY INC

## STAINLESS STEEL CONDUIT AND FITTINGS ALL STAINLESS STEEL • ALL IN STOCK

"Our approach at Gibson may be a little different than most. Quality is our number one priority throughout all of the processing steps, and is one thing we are never willing to sacrifice. Every product we offer is polished to achieve a bright finish. Each individual part is also inspected at various stages of production and assembly and then again during packaging. All items are packaged and labeled individually. All of our conduit is shipped securely in wooden, custom-built crates.

Just as important to the quality of the product we offer, is the quality of the customer service we provide. We strive to give our customers fast and accurate responses. While all Gibson Stainless items are stock items, we do occasionally have less in stock than required by the customer. When this happens, we give our customers realistic and reliable lead times. We hope that doing business with Gibson Stainless is enjoyable and that we are perceived as offering a true quality package made up of both the product and our service."

- \* All of our products are designed to meet and exceed standard electrical industry practices.
- \* Many of our products are UL Listed and most are 100% Made in USA.
- \* Maintaining a very large inventory, we are able to ship over 90% of our orders complete within 24 hours.

## Why Stainless?



Stainless Steel (Gibson)



Hot Dip Galvanized



Zinc Plated

Note: Results after 4-week salt spray test.

### BUILT TO LAST:

In areas where corrosion is a concern, stainless steel is often the choice. Stainless steel has a much greater resistance to rust and corrosion than standard carbon steels and greater resistance than coated steels such as hot dip galvanized or zinc plated. The life of stainless steel in a corrosive environment can be 10 to 20 times, or more, longer than carbon steels or iron.

One of the reasons for enhanced corrosion resistance is the addition of certain elements. The term "stainless steel" is typically used to describe steel which has chromium added. Chromium contents give stainless steel a "self-healing" property. When the surface is scratched or nicked, a microscopic protective oxide film forms on the exposed areas to help protect against further penetration of corrosive elements.

### EASY TO INSTALL:

Gibson Stainless offers threaded rigid conduit and fittings which eliminate extensive installation procedures. These conduit systems can be installed using ordinary hand tools and require very little maintenance or repair.

### AESTHETICALLY PLEASING:

Aside from its corrosion resistance, stainless steel has an aesthetic appeal as well. Gibson Stainless products are provided in a bright, polished finish and do not require any maintenance such as touch up or painting. This bright, polished finish can remain intact for a long period of time.



Gibson Stainless & Specialty, Inc. is an American company, 100% American owned. Machining, finishing, assembly, and packaging are done at Gibson Stainless by Gibson Stainless employees.

Most of our products are 100% Made in the USA, and other various ones are manufactured in the United States. Visit our online catalog to see specific country of origin details on our products: [www.gibsonstainless.com](http://www.gibsonstainless.com).

## INDUSTRIES SERVED

Food Processing Plants • Breweries • Bottling Companies • Refineries • Off-Shore Oil Platforms • Petroleum Plants  
Construction/Bridges • Steel Mills • Tunnels & Mines • Oil & Chemical Plants • Water & Sewage Treatment Plants



**GIBSON STAINLESS®**  
& SPECIALTY INC

Email: [sales@gibsonstainless.com](mailto:sales@gibsonstainless.com)

Web: [www.gibsonstainless.com](http://www.gibsonstainless.com)

Please refer to our website for ongoing product line additions.



**Rigid Conduit**

Type 316SS and  
Type 304SS



**Conduit Accessories**

316SS and 304SS Elbows,  
Couplings, Nipples; 316SS Caps



**Form 8 Conduit Bodies**

LB, T, C,  
LR, LL, TB, X



**Pulling Elbows**



**Device Boxes**

FD, FDC, FDA,  
FDS, FDX, FDDX, Covers



**Hazardous Location Fittings**

GUA Series Conduit Bodies,  
EYS Sealing Fittings, Unions



**Cord Grip Connectors**

With or Without  
Strain Relief Mesh



**Conduit Hubs & Locknuts**

Standard and  
Grounding



**Liquidtight Connectors**

Standard and Grounding  
Straight, 45°, 90°



**Plugs & Reducing Bushings**

Socket and Hex Head Plugs;  
Face and Hex Head  
Reducing Bushings



**Straps & Hangers**

One Hole and Two  
Hole Straps,  
Conduit Hangers



**U-Bolts & Plates**

U-Bolts and Plates  
for Electrical and  
Mechanical Applications



**Conduit Clamps**

Beam Clamps,  
Parallel Clamps,  
Right Angle Clamps

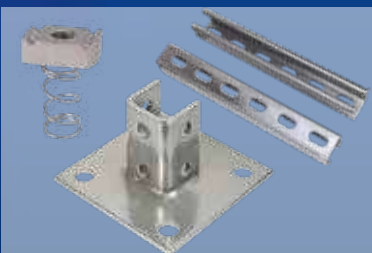

**Strut Accessories**

Strut, Two Piece Clamps,  
Post Bases, Window Clamps,  
Spring Nuts, Square Washers,  
90° Angles, Flat Plates



**Grounding Rod**

316SS and  
304SS Ground Rod,  
316SS  
Ground Rod Clamps



**Hardware**

Hex Head Cap Screws, Hex Nuts, Slotted  
Machine Screws, Washers (Lock, Flat,  
Fender), Threaded Rod, Couplings,  
Wedge Anchors, Drop In Anchors