

STAINLESS STEEL ROD COUPLINGS

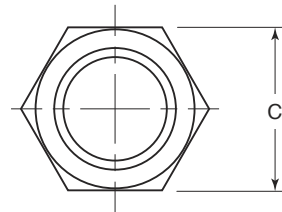

APPLICATION

- Hexagon shaped fittings used to connect two lengths of threaded rod
- Manufactured in stainless steel to help prevent corrosion
- Can be installed using ordinary hand tools and require little maintenance or repair
- Provided in a bright, polished finish that does not require touch up or painting

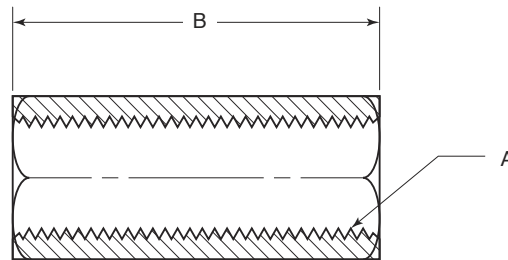
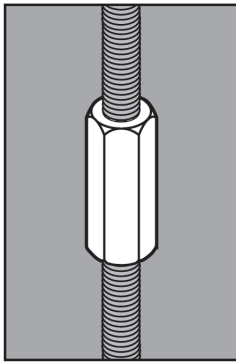

PRODUCT DETAILS

Material:
316 SS

Standards:
ASTM F593

Country of Origin:
Import

Part Number	Size	Pitch (Threads per Inch)	Design Load (lbs.)	Weight/ 100 (lbs.)	-----Dimension (in.)-----		
					A	B	C
9711	¼ in.	20	240	2	¼ - 20 UNC	0.87	0.37
9713	⅜ in.	16	610	4	⅜ - 16 UNC	1.14	0.50
9714	½ in.	13	1,130	6	½ - 13 UNC	1.27	0.62



© 2018 GIBSON STAINLESS & SPECIALTY, INC. - REV 3/2018

PO BOX 847, GREENSBURG, PA 15601
PHONE: 1-800-945-4316 • FAX: 724-838-1544

WEB: GIBSONSTAINLESS.COM